

Langdon Road

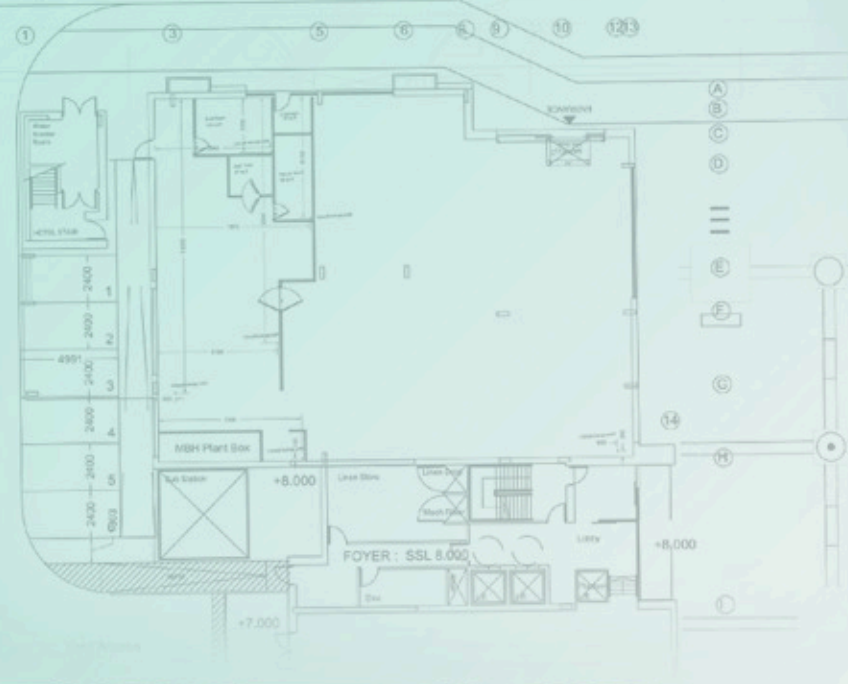

Project Team

Developer	Tesco Express
Contractor	S Dudley and Son Ltd
Project Manager	-
Quantity Surveyor	Stace LLP
Acoustic Consultant	Noise Solutions Ltd
Landscaping	-
Environmental	-
Structural Engineer	-
Signage Contractor	ASG

Project Focus

- Fit Out of a Developers Shell in a Mixed Use Development
- 4500 sq ft Sales Area
- Part of the SA1 Regeneration for Swansea Waterfront, overlooking the "Prince of Wales Dock"
- Located in the ground floor of the Premier Inn, offering local residents the facilities of a convenience supermarket
- Opened November 2010

Swansea